

HELLO KITTY

User's Manual



HELLO KITTY 2-IN-1 PLAYMAT CUBE



© 2011 VTech
Printed in China

91-002607-003 (英)

VTech understands that a child's needs and abilities change as they grow and with that in mind we develop our toys to teach and entertain at just the right level...

vtech *Baby*

Toys that will stimulate their interest in different textures, sounds and colours

I am...

...responding to colours, sounds and textures

...understanding cause and effect

...learning to touch, reach, grasp, sit-up, crawl and toddle

Birth-36 months



Pre-School

Interactive toys to develop their imagination and encourage language development

I want...

...to get ready for school by starting to learn the alphabet and counting

...my learning to be as fun, easy and exciting as can be

...to show my creativity with drawing and music so my whole brain develops

3-6 years



Electronic Learning Computers

Cool, aspirational and inspiring computers for curriculum related learning

I need...

...challenging activities that can keep pace with my growing mind

...intelligent technology that adapts to my level of learning

...National Curriculum based content to support what I'm learning at school

4-10 years



To learn more about this and other VTech® products, visit www.vtechuk.com

INTRODUCTION

Thank you for purchasing the **vTech® Hello Kitty 2-in-1 Playmat Cube!**

This beautifully illustrated 2-in-1 playmat transforms into a fun cube to be continually enjoyed as babies grow.

Use as a playmat to soothe babies with calming melodies whilst entertaining them with the soft hanging characters and press buttons. Turning over the cube introduces Kitty and her family. Little ones are encouraged to find Kitty and her family to hear fun phrases and sound effects!

The attachable panel with 5 colourful buttons teaches shapes and objects, plays 28 melodies.

2 SOFT
CHARACTERS

MIRROR

ON/OFF
BUTTON

5 SHAPED
BUTTONS

SOFT PLAYMAT

FLASHING LIGHT

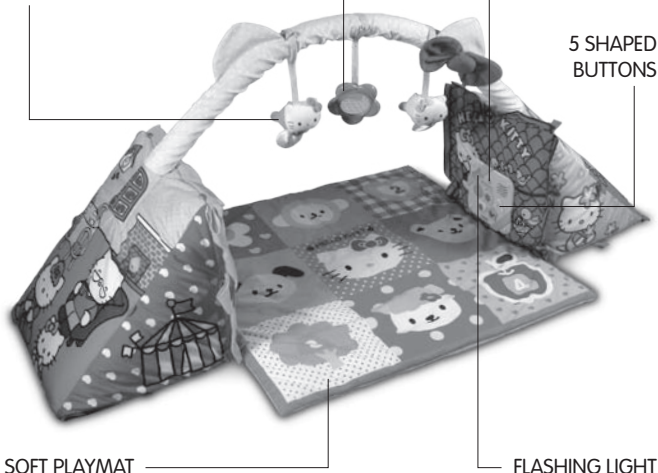

INCLUDED IN THIS PACKAGE

- One User's Manual
- One attachable panel



- One arch



- One blanket



- One hanging mirror



- Two soft characters



- Two inflatable triangles without air



WARNING: All packing materials, such as tape, plastic sheets, packaging locks and tags are not part of this toy, and should be discarded for your child's safety.

NOTE: Please keep this instruction manual as it contains important information.

Unlock the packaging locks:

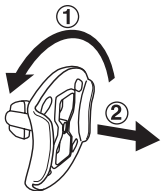

- ① Rotate the packaging lock counter-clockwise through 90 degrees
- ② Pull out the packaging lock

INSTRUCTIONS

BATTERY INSTALLATION

1. Make sure the unit is turned **OFF**.
2. Locate the battery cover on the bottom of the attachable panel. Use a coin or a screwdriver to loosen the screw.
3. Install 2 new 'AA' (AM-3/LR6) batteries following the diagram inside the battery box. (The use of new alkaline batteries is recommended for maximum performance.)
4. Replace the battery cover and tighten the screw to secure the battery cover.

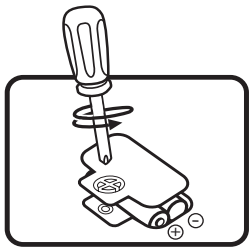

BATTERY NOTICE

- The use of new alkaline batteries is recommended for maximum performance.
- Non-rechargeable batteries are not to be recharged.
- Rechargeable batteries are to be removed from the toy before being charged (if removable).

- Rechargeable batteries are only to be charged under adult supervision (if removable).
- Different types of batteries or new and used batteries are not to be mixed.
- Only batteries of the same or equivalent type as recommended are to be used.
- Batteries are to be inserted with the correct polarity.
- Exhausted batteries are to be removed from the toy.
- The supply terminals are not to be short-circuited.
- The toy is not to be connected to more than the recommended number of power supplies.
- Do not dispose of batteries in fire.

WE DO NOT RECOMMEND THE USE OF RECHARGEABLE BATTERIES.

Disposal of batteries and product



The crossed-out wheeled bin symbols on products and batteries, or on their respective packaging, indicates they must not be disposed of in domestic waste as they contain substances that can be damaging to the environment and human health.

The chemical symbols Hg, Cd or Pb, where marked, indicate that the battery contains more than the specified value of mercury (Hg), cadmium (Cd) or lead (Pb) set out in Battery Directive (2006/66/EC).



The black bar indicates that the product was placed on the market after 13th August, 2005.

Help protect the environment by disposing of your product or batteries responsibly.

For more information, please visit:

www.recycle-more.co.uk

www.recyclenow.com

ASSEMBLY INSTRUCTIONS

To ensure your child's safety, this product should only be assembled by an adult.

To construct the cube

1. Fill the inflatable triangles with air. (No inflator/pump included.)

If you have one, you can use a pump such as an air bed pump to inflate the triangles. Alternatively you can blow air in to the triangle making sure to pinch the nozzle as you blow.

- a. When inflated push the nozzle into the inflatable triangles.
 - b. Ensure to fill the inflatable triangle fully with air before the child uses it.
 - c. Ensure the inflatable triangle is thoroughly filled with air every time before the child uses it.
2. Assemble into a cube by combining the two inflatable triangles together.

Join together where the rope tags meet. Please insure the sides of the cube i.e. the doors and windows of the house all face upright when constructing the cube.

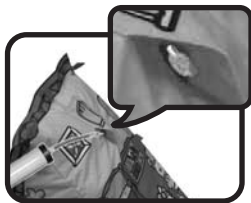

3. Attach the attachable panel to the roof side of one of the triangles.



4. When assembled into a cube put the arch through the spaces in the side of the cube.



To construct the playmat

1. Separate two inflatable triangles.
Attach to the playmat where the rope tags meet.

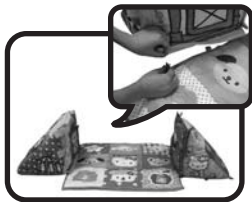

2. Attach the attachable panel to the roof side of one of the triangles.



3. Put the arch into the pocket of the triangles on each side.



4. Hang the three objects from the arch.



To take out the attachable panel

Press the side of the attachable panel on either side as you remove the panel.



PRODUCT FEATURES

1. ON/OFF BUTTON

To turn the unit **ON** or **OFF**, press the **ON/OFF Button** ().

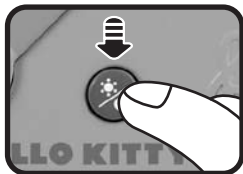

2. AUTOMATIC SHUT-OFF

To preserve battery life, the **VTech® 2-in-1 Hello Kitty Playmat Cube** will automatically power-down approximately 20 seconds after the sounds have finished. The unit can be turned on again by pressing any button but not by activating the sensors.

ACTIVITIES

1. Press the ON/OFF button. You will hear an opening song and phrase. This will vary depending on which mode is activated and whether the panel is attached. The light will flash with the sounds.

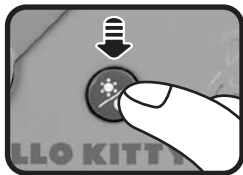

2. Removable Panel

The attachable panel attaches to the side of one of the triangles to be used with the playmat or cube. Included within the panel are 5 shape buttons, motion sensor and recognition sensor.



3. **Playmat Mode**

Playmat mode is activated when the panel is attached and Kitty side is recognised (i.e. Mimmy side is facing down)



In this mode pressing the buttons will play soothing melodies and nature sound effects. The light will flash with sounds.



4. **Cube Mode**

Cube mode is activated when the cube is formed and the panel is attached. Pressing the buttons teaches shapes and objects.

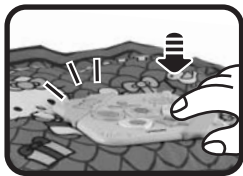

Turning over the cube activates the recognition sensor to introduce Kitty and her family.



5. **Motion sensor**

In each of the modes the motion sensor plays sound effects over the songs and melodies.

MELODY LIST

1. Alouette
2. Shoofly
3. Polly Wolly Doodle
4. The Farmers in the Dell
5. Oh Susanna
6. Greensleeves
7. Fur Elise
8. Clair De Lune (lullaby and playful styles)
9. Brahms Lullaby
10. Moonlight Sonata
11. Pachelbel Canon
12. Vivaldi - Spring
13. To a Wild Rose (lullaby and playful styles)
14. Rock-a-bye Baby
15. Twinkle Twinkle Little Star
16. Beautiful Dreamer
17. Lavender's Blue
18. Four Seasons Winter 2
19. Waltz of the Flowers
20. Water Music (lullaby and playful styles)
21. Rondo a Capriccio
22. Nocturne
23. Happy Farmer (lullaby and playful styles)
24. Morning - Peer Gynt Suite
25. Ode to Joy
26. Three Little Kittens
27. Oh Where, Oh Where Has My Little Dog Gone?
28. Three Blind Mice

SING-ALONG SONG LYRICS

SONG 1

Turn over the cube,
meet Kitty and her family,
Let's play together,
Let's have fun forever!

SONG 2

Hello Kitty,
Hello all,
There're lots of things to explore!

CARE & MAINTENANCE

1. Keep the unit clean by hand washing (arch and two triangles) or machine washing (two soft characters and blanket) after removing the music box. You can also see the washing instruction labels sewn onto these objects.
2. Keep the unit out of direct sunlight and away from any direct heat source.
3. Remove the batteries when the unit is not in use for an extended period of time.
4. Do not drop the unit on hard surfaces and do not expose the unit to moisture or water.

TROUBLESHOOTING

If for some reason the program/activity stops working or malfunctions, please follow these steps:

1. Please turn the unit **OFF**.
2. Interrupt the power supply by removing the batteries.
3. Let the unit stand for a few minutes, then replace the batteries.
4. Turn the unit **ON**. The unit should now be ready to play again.
5. If the product still does not work, replace with a new set of batteries.

If the problem persists, please call our Consumer Services Department on 01235 546810 (from UK) or +44 1235 546810 (outside UK) and a service representative will be happy to help you.

IMPORTANT NOTE:

Creating and developing **VTech®** products is accompanied by a responsibility that we take very seriously. We make every effort to ensure the accuracy of the information, which forms the value of our products. However, errors sometimes can occur. It is important for you to know that we stand behind our products and encourage you to call our Consumer Services Department on (01235) 546810 (from UK) or +44 1235 546810 (outside UK) with any problems and/or suggestions that you might have. A service representative will be happy to help you.

CLASS 1
LED PRODUCT

Sanrio License

Approved by SANRIO

LICENSED PRODUCT OF

VTech UK



© 1976, 2011 SANRIO CO., LTD.



PRODUCT WARRANTY



Thank you for choosing this quality product from VTech. We hope it will bring many hours of entertainment, imaginative play and learning.

1. The product detailed above is covered by a one year warranty from the date of purchase, against any defects in materials or workmanship.
2. The product may be returned to the place of purchase. Alternatively the product can be returned to VTech Electronics Europe plc (see address below), with proof of purchase, without proof of purchase no replacement will be provided.
3. VTech Electronics Europe plc will examine the product and if it is found to be defective due to faulty materials or workmanship, will replace the product at their discretion.
4. If the product covered by this warranty is damaged due to misuse, modification or unauthorised repair, or because of faulty batteries, battery discharge or incorrect electrical connections, then this warranty becomes void.
5. This warranty is personal to the original purchaser and is not transferable.
6. Breakages to the LCD screen are not covered by the warranty.
7. Returns to VTech Electronics Europe plc should include a cheque or postal order for £1.50 towards the cost of return postage and packaging.
8. Products returned to VTech Electronics Europe plc, should be addressed as follows and packed carefully to avoid damage in transit (Please do not include batteries or adaptor).
Please include details of the fault together with your name and address.

VTech Electronics Europe plc, c/o Tablogix Limited, 200 Milton Park, Abingdon, Oxon OX14 4TA

THIS WARRANTY IS OFFERED AS AN EXTRA BENEFIT AND DOES NOT AFFECT CONSUMERS' STATUTORY RIGHTS.

This warranty is valid for the UK and Eire only. For products purchased outside the UK and Eire, please contact your local distributor or place of purchase.

